



Automatic swing door operators

S200 M200

MAX. CAPACITY 250 KG

MAX. CAPACITY 250 KG

Automatic door operators TOPP, model S200 and M200, for pedestrian swing doors. They may be used for doors with 700mm widths with maximum weight of 250kg and 1200 widths with maximum weight of 130kg respectively. Power supply 230V~ 50 Hz. With a minimalist and sober design, with an elegant aluminium cover, are the ideal solution for prestigious environments, both residential and commercial: shops, offices, hotels and other situations that require an automatic swing door. Simple and easy to install due to the fitting plate, the adjustable settings on the electronic board and the side switches for the power supply, functions and reset selection. In compliance with the EN16005 Standard, the S200 and M200 work in either Full Power and Low Energy modes. The Low Energy mode does not require safety sensors due to the electronic control of force and weight. Due to the combination of 3 different types of arm - slide track arm, push arm and elbow slide track arm - with extension systems, the mechanisms are very easy to configure and can be adapted to any wall and door type. In case of a power failure, a long-life battery pack will assure the operator's functioning.

S200 tested in accordance with the EN1634-1 Standard (fire resistance test).



Full Power or Low Energy modes can be easily selected from the electronic board.

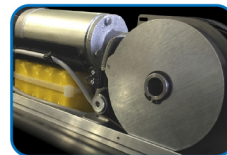

On-board batteries without automation changes on dimension.



Fitting plate for an easy installation to the wall.

TECHNICAL SPECIFICATIONS

SPECIFICATIONS	S200	M200
Power supply	230V ~ 50/60 Hz	230V ~ 50/60 Hz
Operation modes	Full Power or Low Energy	Full Power or Low Energy
Working system	Opening by motor – Closing by spring	Opening by motor – Closing by motor
Power supply for external accessories	24V - 500mA max	24V - 500mA max
Absorption	1 A	0,65 A
Absorbed power	230W	150W
Durability	1.000.000 cycles	1.000.000 cycles
Max. opening speed	50°/second	50°/second
Adjustment of automatic closing time	from 0 to 60s	from 0 to 60s
Max. door-panel weight	250kg for panel 700mm – 130kg for panel 1200mm	250kg for panel 700mm – 130kg for panel 1200mm
Clear passage width		
with push arm	min 600mm – max 1600mm	min 600mm – max 1600mm
with slide track arm	min 650mm – max 1600mm	min 650mm – max 1600mm
with elbow slide track arm	min 700mm – max 1600mm	min 700mm – max 1600mm
Max. opening angle of push arm:	115°	115°
Max. opening angle of slide track arm	95°	95°
Dimensions	580mm x 130mm x H110mm	643mm x 132mm x H74mm



Life Time Warranty
On Workmanship



*24 Months on Equipment
Supplied and installed

*Terms and conditions apply



S200

M200

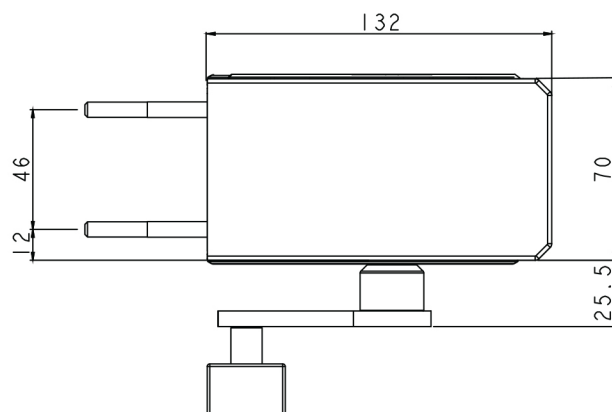
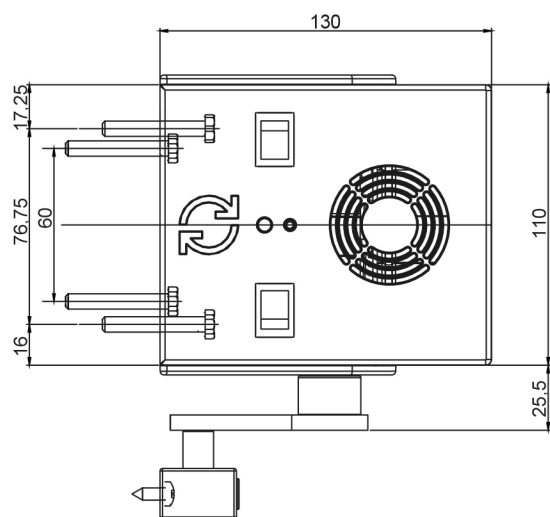

S200 AND M200 AUTOMATIC SWING DOOR OPERATORS

Max. capacity from 250kg for leaf 700mm to 130kg for leaf 1200mm

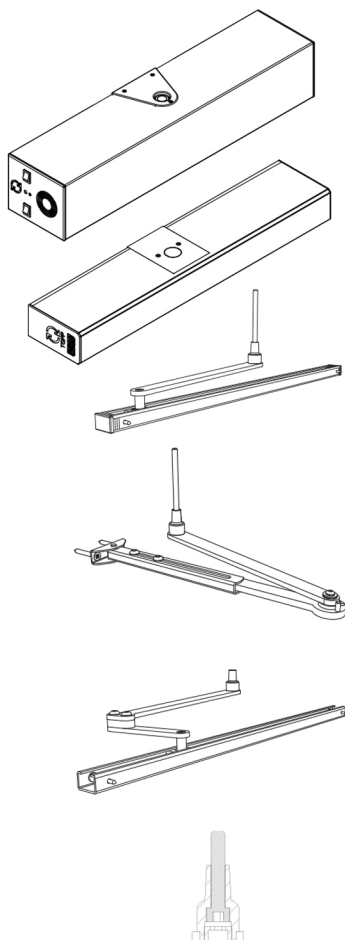

3S10001

S200 - automatic swing door operator with spring and on-board battery (250kg for leaf of up to 700mm – 130kg for leaf of up to 1200mm)

3S11010

M200 - automatic swing door operator with on-board battery (250kg for leaf of up to 700mm – 130kg for leaf of up to 1200mm)

3S1020

SA1 Slide track arm (for overlap depths from 0 up to max. 30 mm)

3S1010

AA1 Push arm (for lintel depths from 0 up to max. 100mm)

3S1011

AA2 Push arm (for lintel depths from 101 up to max. 200mm)

3S1012

AA3 Push arm (for lintel depths from 201 up to max. 300mm)

3S1030

EA1 Elbow slide track arm (for lintel depths from 0 up to max. 100mm)

3S1031

EA2 Elbow slide track arm (for lintel depths from 101 up to max. 220mm)

3S1100

PS1 Arm extension 25mm

3S1101

PS2 Arm extension 50mm

3S1102

PS3 Arm extension 75mm

3S1180

KIT S200 operator junction cover for double swing door (2 m)

3S1181

KIT M200 operator junction cover for double swing door (2 m)

Note: Electronic board with on-board receiver and possibility to control through TS1S radio remote control selector (as an alternative to MS1S and KS1S selectors).



S200 AND M200 ACCESSORIES



8E1725	WS6 Microwave unidirectional activation sensor
8E1731	IS6M Master safety sensor for swing doors (length 700mm) – black. Certified according to EN16005
8E1732	IS6M Master safety sensor for swing doors (length 1200mm) – black. Certified according to EN16005
8E1734	IS6S Slave safety sensor for swing doors (length 700mm) – black. Certified according to EN16005
8E1735	IS6S Slave safety sensor for swing doors (length 1200mm) – black. Certified according to EN16005
8E1771	BF1 2 pieces Flatscan technology safety sensors – white
8E1772	BF1 2 pieces Flatscan technology safety sensors – black
8E1042	MS1S Analog functions selector for swing door automation
8E1043	KS1S Analog functions selector key operated for swing door automation
8E1083	KC1S key switch for opening/closing
8E1055	TS1S 4-functions wireless selector for swing door automation (open, close, exit onlymode, automatic mode)
8E1832	DS2S LCD digital function selector with advanced end-user/installer programming functions for swing door automation – white
8E1833	DS2S LCD digital function selector with advanced end-user/installer programming functions for swing door automation – black
8E1890	External connector kit for DS2S (with wire L=1m)
8E1094	HS3 touchless infrared activation switch
8E1143	HS4T touchless infrared activation switch wireless
8E1141	HS4R receiver for HS4T
8E1152	HS2S touchless switch for the activation/deactivation of the electric-lock with occupied/vacant indication
8E1091	PU1 Ultra-flat activation push pad
8E1142	TP1 Fingers anti-entrapment system for automatic swing door hinges (L=1930mm)
8E1127	EB15 Magnetic electric lock for swing door
8C0477	SwitchBoxDC Wifi device for the door opening via smartphone or tablet